

XD5

MINI PILING RIG



 **GEAX**

XD5

MINI PILING RIG

XD series machines are the smallest hydraulic piling rigs in the world. They are designed to work in extremely tight spaces, limited headroom, and jobsites difficult to access for any other standard piling rig. The minimum working height is 2.6 m (8.5') and the minimum width 1 m (3.3').

Despite the compact size, the XD series is equipped with all the features of larger rigs, such as auxiliary winch, depth meter, spin off speed and winch limit switches.

The patented drilling attachments include a rotary system along with a telescopic Kelly bar, mounted on the mast with a gimbal joint, which guarantees always a perfect verticality. A hydraulic cylinder and the interlocking Kelly bar provide the crowd force necessary to overcome harder soils.

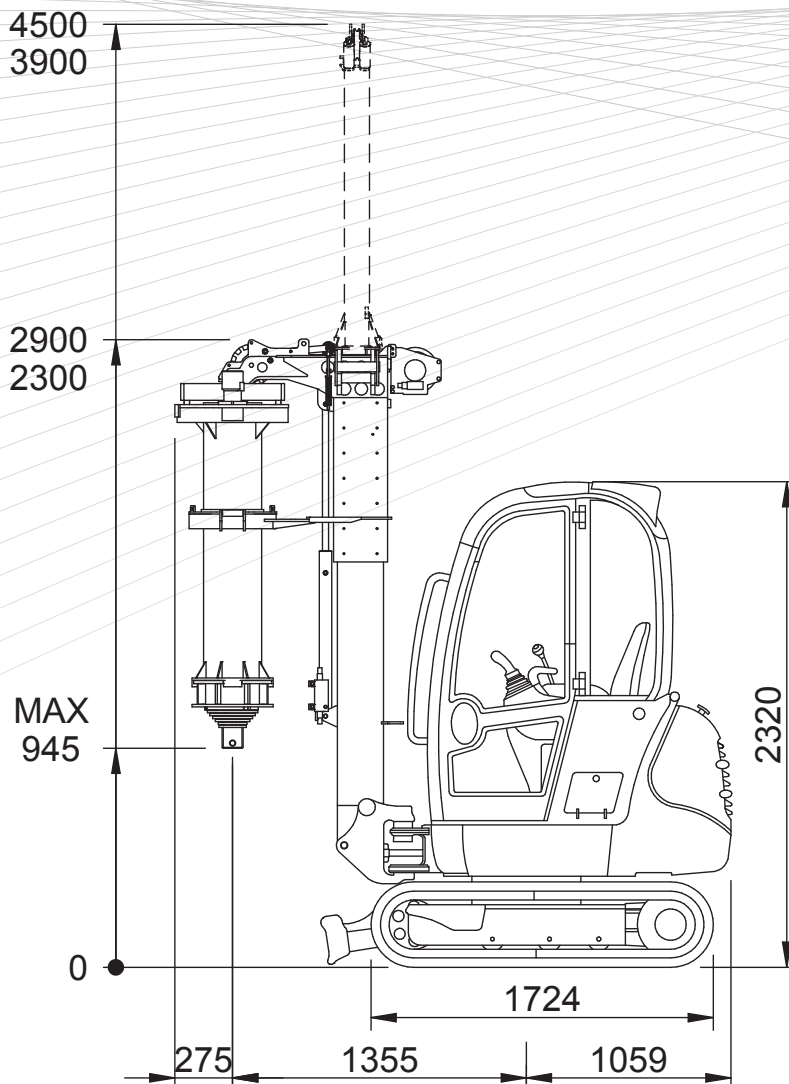

XD5

TECHNICAL DATA SHEET

| | | |
|-------------------------|---------------------|---------------------------|
| BASE | | JCB 8020 CTS |
| Engine | <i>type</i> | Perkins 403D-II |
| Engine power | <i>kW (hp)</i> | 14.7 (19.7) |
| Undercarriage length | <i>mm - ft</i> | 1.724 - 5.7 |
| Width over tracks | <i>mm - ft</i> | 1.002 ÷ 1.362 - 3.3 ÷ 4.5 |
| Shoe width | <i>mm - in</i> | 250 - 9.8 |
| HYDRAULIC SYSTEM | | |
| Main pump | <i>l/min</i> | 44 |
| Auxiliary pump | <i>l/min</i> | 11.4 |
| Hydraulic pressure | <i>bar</i> | 230 |
| MAST | | |
| Forward inclination | <i>deg</i> | 4 |
| Backward inclination | <i>deg</i> | 4 |
| Lateral inclination | <i>deg</i> | 4 |
| Mast vertical stroke | <i>mm - ft</i> | 600 - 2 |
| ROTARY | | |
| Nominal torque | <i>kNm - lbf ft</i> | 6 - 4.420 |
| Drilling speed | <i>rpm</i> | 20 ÷ 40 |
| Spin off speed | <i>rpm</i> | 40 |
| WINCHES | | |
| Main winch line pull | <i>kN - lbf</i> | 8 - 1.800 |
| Aux winch line pull | <i>kN - lbf</i> | 5 - 1.130 |
| CROWD SYSTEM | | |
| Pull down force | <i>kN - lbf</i> | 15 - 3.370 |
| Extraction force | <i>kN - lbf</i> | 25 - 5.620 |
| EXCAVATION | | |
| Max pile diameter | <i>mm - in</i> | 500 - 20 |
| Max pile depth | <i>m - ft</i> | 11.5- 37.7 |
| Min working height | <i>mm - ft</i> | 2.600 - 8.5 |
| TRANSPORT | | |
| Length | <i>mm - ft</i> | 2.690 - 8.82 |
| Width | <i>mm - ft</i> | 1.002 - 3.3 |
| Height | <i>mm - ft</i> | 2.320 - 7.6 |
| Weight | <i>kg - lbs</i> | 2.400 - 5.300 |

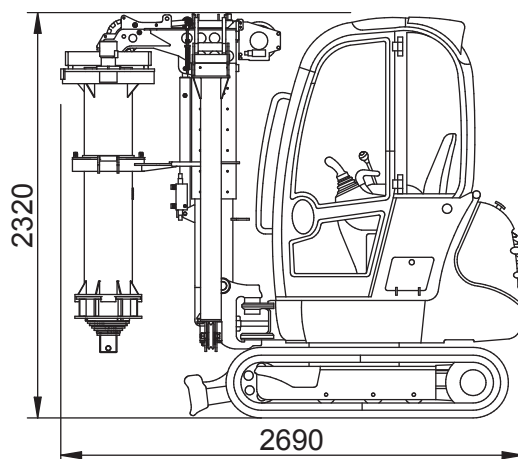



Via Campoceraso 13 - 60027 OSIMO (AN) ITALY

Tel: +39 0717131953 - Fax: +39 071715199
geax.it - info@geax.it